

Product Catalogue

Industrial Cable Glands & Accessories
Earthing & Lightning Protection & Accessories
Other Electrical Accessories



Connectors to the world...

GLOBAL BRASS & ALLOY (INDIA)

An ISO 9001 Certified Company

from a Movement
to a Revolution

Building Strong
Connections



Since 1986



VBI Group of Company



MANUFACTURER & EXPORTER OF ELECTRICAL CABLE ACCESSORIES

BRASS CABLE GLANDS & ACCESSORIES | CABLE TERMINAL ENDS (LUGS) & IN LINE CONNECTORS | EARTHING & LIGHTNING PROTECTION ACCESSORIES

www.globeworldwide.com

ABOUT US

VBI Group of Company - GLOBAL BRASS & ALLOY (INDIA) an ISO 9001-2015 certified company, one of the most respected and renowned manufacturers of high quality electrical engineering products has established a brand **GLOBEX** at Jamnagar, Gujarat, comprising of more than 40000 Sq.foot area, incorporating new technology & state of art machineries for manufacturing wide range of its products. We at GLOBAL BRASS & ALLOY (INDIA) produces and export high quality accurate range in segment of:

- BRASS CABLE GLANDS & ACCESSORIES,
- CABLE TERMINAL ENDS (LUGS) & IN-LINE CONNECTORS,
- EARTHING & LIGHTING ACCESSORIES,
- CONDUCT FITTINGS,
- OTHER ELECTRICAL ACCESSORIES PRODUCTS.

Our products follow widely accepted international standard like British Standard. European Norm, UL, ASTM, JIS, ANSI, DIN, UL, NFC & IS (Indian standard) etc. And posses the capacity to develop and manufacture products as per the client's design and specifications.

MISSION

Our commitment to supply International standard quality products and services meeting the market demand in all circumstances. Our aim to reach the expectations of our customers and provide them the quality products which carry the customer satisfaction test anywhere across the Globe. Working with the uprightness, focus on the excellence (quality) of the product and the after sales services to guarantee trust, is what we at GLOBEX strive for.

VISION

Our vision endowing our clients with the best quality products of electrical engineering along with most reliable services in order to relish the achievement of our vision being the leading manufacturer (corporation) in our field.

QUALITY

At **GLOBEX**, Quality is a long history of success and recognition. Today our company is one of the leading Indian establishment to have adjusted and certified its progress according to the strict regulatory standards:

- QUALITY (ISO 9001:2015)
- ENVIRONMENT (ISO 14001:2015)
- HEALTH & SAFETY (OHSAS 18001:2007)

CERTIFICATION

- BIS (Bureau of Indian Standards) approval
- CE approval
- CSIR – CIMFR, Dhanbad approval of double compression Cable Glands.
- Petroleum & Explosives Safety Organization (PESO)/ CCOE approval for flame proof equipment.
- ERDA, Vadodara approval on Aluminum Cable Terminal ends (LUGS) & in-line connectors.
- CPRI, Bangalore approval on Copper Cable Terminal ends (LUGS) & in-line connectors.

Product Name	Page No.
Technical Data & Gland Selection Chart	01
BW Cable Gland (3 Part) & (2 Part)	02
CW Cable Gland (3 Part) & (4 Part)	03
A2 Cable Gland	04
A1 / A2 Cable Gland	} 05
Aluminium Cable Gland	
E1W Cable Gland	06
E1W / E1WF Industrial Gland	} 07
BW Rotating Cone Gland	
PG Brass Cable Gland (Nickel Plated)	} 08
IP68 Metal Gland (Metric Thread)	
IP68 Metal Gland (PG Thread)	} 09
Marine Cable Gland	
EMC Cable Gland (IP68 Rating - Nickel Plated)	} 10
Alco Cable Gland	
TRS Cable Gland	
CXT Cable Gland	} 11
Wiping Gland	
Cable Gland Kit	12
Double Compression Type Cable Gland	13
Single Compression Type Cable Gland	14
Shroud / Hood / Sleeves, Earthing Tag, Lock Nut	} 15
Brass Reducer, Brass Stopping Plug	
Mechanical Cable Lugs	} 16
Copper Bonded Ground Rod	
Coupler, Driving Stud	17
Clamp A, B, C, D Type	18
U Bolt Clamp, Oblong Test Clamp, DC Tape Clip	} 19
Tape Clip, Test Bond/ Test Clamp	
Cable to Tape Junction Clamp, Square Tape Clamp	20
Brass Cable Clip, Tee Clamp, Jointing Clamp, Cast Cable Saddle	} 21
Linetape / Split Bolt	
Brass Neutral Link / Earthing Terminals	22
Brass Make and Female Bush, Brass Adapter 1 Pc. / 2 Pc.	23
PVC Coated Galvanized Flexible Conduit, Dark Flexible Steel Conduit System	24
Overview of Products - Cable Terminal Ends(Lugs) & In-line Connectors	

TECHNICAL DATA

General Specification : BS Standard BS 6121 Part I 1989

Material	a) Glands	:	Bodies, Caps & Rings are manufactured from brass also in nickel & tin plated.
	b) Seals	:	Nitrile Rubber (also Neoprene)
	c) Shroud	:	Black Poly Vinyl Chloride (PVC)
	d) Earth tag	:	Brass Self Colour
	e) Locknut	:	Brass of Galvanised
	Entry Thread	:	ISO metric (also available on request NPT thread & PG thread).

GLAND SELECTION CHART

The gland sizes recommended are in accordance with calculations based on cables manufactured on BS 6346 (1969) and GLOBEX does not accept any responsibility for cables that prove to deviate materially from the nominal diameters quoted in BS-6346 (1969).

600/100V stranded copper conductors PVC insulated with steel wire armour & PVC sheathed overall

Cable Size Conductor		Number of Cores												
Nom. area mm ²	Neutral	1	2	3	3.1/2	4	5	7	10	12	19	27	37	48
1.5	-	16S	20/16	20S	-	20S	20	20	20	25S	25	25	32	32
2.5	-	16S	20S	20S	-	20	20	20	25S	25	25	32	40S	40
4	-	16L	20	20	-	20	20	25S	25S	25	32S	32	40S	
6	-	20S	20	20	-	20								
10	-	20S	25S	25S	-	25S								
16	-	20	25S	25S	-	25								
25	16	20	25S	25	25	25								
			25	25		32S								
35	16	20	25	32S	32S	32								
			25	32		32								
50	25	25S	32S	32	32	40S								
70	35	25	32	40S	40	40								
95	50	25	40S	40	50S	50S								
120	70	25	40	50S	50S	50								
150	70	32S	40	50S	50	63S								
185	95	32	50S	50	63S	63S								
240	120	40S	50	63S	63	63								
300	150	40	63S	63	75S	75S								
300	185	40	63S	-	75	75								
400	185	50S	63	75S	75	90S								
500	-	50	-	75	90	90								
630	-	50	-	-	-	-								
800	-	63S	-	-	-	-								
1000	-	63	-	-	-	-								

* Any dimensional changes are purely the result of our endeavor to constantly improve the efficiency of the product.

* **Disclaimer** : Product sizes mentioned in the entire catalogue are for reference purpose only. The precise dimensional details would be made available post your discussion with us. Please contact or write to us at info@globexworldwide.com for further information.

BW CABLE GLAND (3 Part)

We are engaged in offering BW Cable Gland (3 PART).

Material : Brass (Aluminium also available on request)

Finish : Brass finish (Bright Nickel plated/Tin/Cadmium/chrome also available on request)

Application : For use with armor or braided cable, secures armoring & provides electrical continuity between armor & gland entry component made used it dry and indoor condition

Design Features : 2 part armor lock, Knurled armor lock produces a low resistance earth clip.

Available in CIEL (cast integral earth lug), these are used with armor or braided cable. Further, this secure armoring & provides electrical continuity between armor & gland entry component that are used for dry and indoor condition.

Standard : BS 6121

IP Rating : IP30

Operating Temp. Range : -80° to +600°C

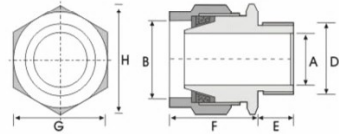

Cable Gland Size	Cable Dimensions Accommodate		Gland Dimensions						Globex Product Code
	Cable Bedding	Overall Cable	Armour Range	ISO Entry Thread		Protrusion Length	Hexagonal Size		
				Dia	Length		Across Flat	Across Corners	
Dia. A Max.mm	Dia. B Max.mm	Min./ Max.	Dia D mm	Length E mm	F mm	G mm	H mm		
16 S	8.0	12.0	0.8/1.25	16.0	9.0	20.0	20.0	22.0	GBW - 16 S
16 L	8.6	13.5	0.8/1.25	16.0	9.0	20.0	20.0	22.0	GBW - 16 L
20 S	12.3	17.0	0.8/1.25	20.0	9.0	20.0	22.0	24.0	GBW - 20 S
20 L	14.3	20.0	0.8/1.25	20.0	9.0	20.0	25.0	27.0	GBW - 20 L
25 S	19.0	23.3	1.0/1.6	25.0	9.0	21.0	31.0	34.0	GBW - 25 S
25 L	20.4	27.0	1.0/1.6	25.0	9.0	21.0	33.5	37.0	GBW - 25 L
32 S	23.5	28.5	1.6 / 2.0	32.0	9.5	25.0	35.0	38.5	GBW - 32 S
32 L	26.5	33.5	1.6 / 2.0	32.0	9.5	25.0	40.0	45.0	GBW - 32 L
40 S	31.0	37.5	1.6 / 2.0	40.0	12.5	25.0	44.5	49.0	GBW - 40 S
40 L	33.0	41.5	1.6 / 2.0	40.0	12.5	25.0	48.5	54.0	GBW - 40 L
50 S	39.5	48.0	2.0 / 2.5	50.0	12.5	28.0	56.5	62.5	GBW - 50 S
50 L	44.0	54.0	2.0 / 2.5	50.0	12.5	30.0	61.0	67.5	GBW - 50 L
63 S	50.5	60.5	2.5	63.0	14.0	33.0	69.3	77.0	GBW - 63 S
63 L	56.0	65.0	2.5	63.0	14.0	33.0	75.3	84.3	GBW - 63 L
75 S	62.5	72.0	2.5	75.0	14.0	40.0	83.5	92.5	GBW - 75 S
75 L	67.5	78.5	2.5	75.0	14.0	40.0	89.5	99.0	GBW - 75 L
90 S	75.0	85.0	3.15	90.0	20.0	48.0	100.0	110.0	GBW - 90 S
90 L	78.0	88.5	3.15	90.0	20.0	48.0	102.0	115.0	GBW - 90 L
100 S	86.0	94.0	3.15	100.0	20.0	55.0	110.0	119.0	GBW - 100 S
100 L	89.5	99.0	3.15	100.0	20.0	55.0	115.0	124.0	GBW - 100 L

Kit Packing : Kit packing is inclusive of Gland, Earth Tag & PVC Shroud in one Polythin Bag.

BW CABLE GLAND (2 Part)

Size : 20mm S&L to 100mm S&L

Material : Brass

Finish : Natural Brass

Standard : BS 6121

IP Rating : IP20

Operating Temp. Range : -80° to +600°C

Kit Packing Available



CW CABLE GLAND (3 Part)

"We offer quality and durable range of CW Cable Gland (3 PART). These are used both indoor and outdoor, in all climatic conditions, as it is weatherproof & waterproof. Our range is further provided with a wire that is used instead of a knurled cone."

Material : Brass (Aluminium also available on request)

Finish : Brass finish (Bright Nickle plated/Tin/Cadmium/chrome also available on request)

Application: » For use with armoured cable. » Secures armoring and provides electrical continuity between armour and gland entry component » Also provides a seal on the outer sheath of the cable thus ensuring no damage to cable sheathing.

Design Features : 2 part Armour/Earth Lock, Knurled Armour Lock produces a low resistance earth clip.

Also available in CIEL(cast integral earth lug) for orders add "C" to prod. code.

Standard : BS 6121

IP Rating : IP66

Operating Temp. Range : Standard Seals -20° to +80°C

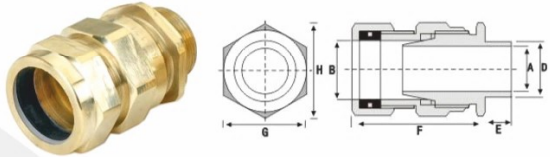

Cable Gland Size	Cable Dimensions Accommodate			Gland Dimensions						Globex Product Code
	Cable Bedding	Overall Cable		Armour Range	ISO Entry Thread		Protrusion Length	Hexagonal Size		
		Dia. A Max.mm	Min.mm	Max.mm	Min./Max.	Dia D mm		Length E mm	Across Flat G mm	
16 S	8.0	9.0	11.0	0.9	16	10.0	40.0	20.0	22.5	GCW - 16 S
16 L	9.0	11.0	13.0	0.9	16	10.0	40.0	20.0	22.5	GCW - 16 L
20 S	12.5	11.0	15.0	0.9 / 1.25	20	10.0	42.0	22.0	24.0	GCW - 20 S
20 L	14.3	16.0	19.0	0.9 / 1.25	20	10.0	42.0	26.0	29.0	GCW - 20 L
25 S	18.4	19.5	23.6	1.25 / 1.6	25	10.0	44.0	31.0	34.0	GCW - 25 S
25 L	20.7	23.0	27.0	1.25 / 1.6	25	10.0	44.0	34.9	38.0	GCW - 25 L
32 S	26.5	27.0	31.0	1.6 / 2.0	32	10.0	46.0	41.0	45.7	GCW - 32 S
32 L	27.0	28.5	32.5	1.6 / 2.0	32	10.0	46.0	41.3	46.0	GCW - 32 L
40 S	31.7	33.0	37.0	1.6 / 2.0	40	13.5	50.0	45.0	50.0	GCW - 40 S
40 L	33.3	34.0	39.0	1.6 / 2.0	40	13.5	50.0	49.0	54.0	GCW - 40 L
50 S	39.8	41.0	46.0	2.0 / 2.5	50	14.0	57.0	56.0	62.7	GCW - 50 S
50 L	44.0	45.0	50.0	2.0 / 2.5	50	14.0	57.0	62.3	69.5	GCW - 50 L
63 S	50.5	54.0	59.0	2.5	63	14.0	70.0	72.5	81.0	GCW - 63 S
63 L	56.0	57.0	62.0	2.5	63	14.0	61.0	76.0	85.0	GCW - 63 L
75 S	62.7	65.0	71.0	2.5	75	15.0	65.0	85.0	95.0	GCW - 75 S
75 L	67.9	71.5	77.5	2.5 / 3.0	75	15.0	66.0	91.0	103.0	GCW - 75 L
90 S	76.0	78.0	84.0	3.15	90	20.0	80.0	100.0	110.0	GCW - 90 S
90 L	78.0	83.0	89.0	3.15	90	20.0	82.0	103.0	114.0	GCW - 90 L
100 L	88.0	90.0	101.0	4.00	100	20.0	85.0	115.0	125.0	GCW - 100 L

Kit Packing : Kit packing is inclusive of Gland, Earth Tag & PVC Shroud in one Polythin Bag.

CW CABLE GLAND (4 Part)

Similar in application and design to the CW (4 part) gland. However an extra component is added, a cone ring. This prevents rotation of the wire and is used instead of a knurled cone.

Size : 20mm S&L to 100mm S&L

Material : Brass

Finish : Natural Brass

Standard : BS 6121

IP Rating : IP66

Operating Temp. Range : Standard Seal -20° to +80°C

Kit Packing Available

Note : Full range of CW Cable Gland with Blue color seal / washer is available.

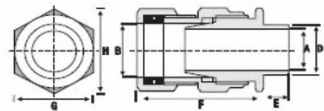

A2 CABLE GLAND

We offer a wide range of A2 Cable Gland that is designed with outer displacement seal. Used for unarmored cables with rubber outer sheath, these are suitable for indoor and outdoor application.

Application : For use with unarmoured cables with rubber outer sheath. Secures outer sheath of cable. Displacement seal concept makes it suitable for indoor and outdoor application.

Design Features : Outer displacement seal.

Material : Brass

Finish : Brass Finish or Nickle Finish

Standard : BS 6121

IP Rating : IP66 & IP68

Operating Temp. Range : Standard Seals -20° to +80°C

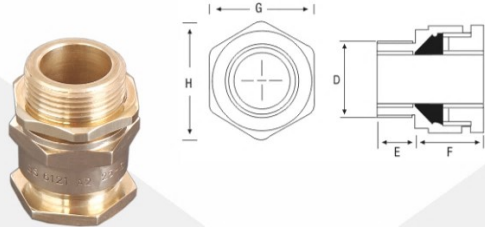

Cable Gland Size	Cable Dimensions Accomodate		Gland Dimensions					Globex Product Code
	Overall Dia. B		ISO Entry Thread		Approx Length from Shoulder F mm	Hexagonal Size		
	Min.mm	Max.mm	Dia D mm	Length E mm		Across Flat G mm	Across Corners H mm	
16 S	4	7	16	10	20	21	24	GA2 - 16 S
16 L	5.5	8.5	16	10	22	21	24	GA2 - 16 L
20 S	8.5	11.5	20	10	24	22	24	GA2 - 20 S
20 L	13	14	20	10	24	24	26	GA2 - 20 L
25 S	13.5	17.5	25	10	25	27	30	GA2 - 25 S
25 L	16	20	25	13	26	30	33	GA2 - 25 L
32 S	19	23	32	13	28	36	40	GA2 - 32 S
32 L	22	26	32	14	28	36	40	GA2 - 32 L
40 S	24	29	40	15	31	44	49	GA2 - 40 S
40 L	28	33	40	15	31	46	50	GA2 - 40 L
50 S	35	40	50	15	33	55	61	GA2 - 50 S
50 L	39	44	50	15	33	58	64	GA2 - 50 L
63 S	45	50	63	15	35	67	74	GA2 - 63 S
63 L	50	55	63	15	35	69	76	GA2 - 63 L
75 S	56	62	75	15	35	78	87	GA2 - 75 S
75 L	59	65	75	15	35	81	90	GA2 - 75 L
90 S	69	75	90	20	50	100	112	GA2 - 90 S
90 L	72	78	90	20	50	100	112	GA2 - 90 L
100 L	83	89	100	22	50	112	125	GA2 - 100 L

Kit Packing : Kit packing is inclusive of Gland, Earth Tag & PVC Shroud in one Polythyn Bag.

A1 / A2 CABLE GLAND

We offer a wide range of A1 / A2 Cable Gland that is designed with outer displacement seal. Used for unarmored cables with rubber outer sheath, these are suitable for indoor and outdoor application.

Material : Brass

Finish : Brass Finish or Nickel Finish

Standard : BS 6121

IP Rating : IP66 & IP68

Operating Temp. Range : Standard Seals -20° to +80°C

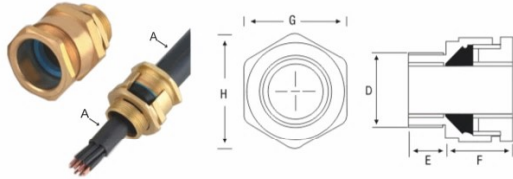

Cable Gland Size	Cable Dimensions Accomodate		Gland Dimensions					Globex Product Code
	Overall Dia. B		ISO Entry Thread		Approx Length from Shoulder F mm	Hexagonal Size		
	Min.mm	Max.mm	Dia D mm	Length E mm		Across Flat G mm	Across Corners H mm	
16 L	5	9	M16	10	25	22	23.5	A1/A2 - 16 L
20 S	8	12	M20	13.5	25	24	26	A1/A2 - 20 S
20 L	10	14	M20	13.5	25	27	30	A1/A2 - 20 L
25 S	11.5	17	M25	15	30	30	32.5	A1/A2 - 25 S
25 L	13.5	20	M25	15	30	34	37	A1/A2 - 25 L
32 S	19	26	M32	15	29	41	44	A1/A2 - 32 S
32 L	20	26.5	M32	15	29	41	44	A1/A2 - 32 L
40 S	22.5	31	M40	15	34	50	54.5	A1/A2 - 40 S
40 L	24	32	M40	15	34	50	54.5	A1/A2 - 40 L
50 S	32	38	M50	15	34	55	60	A1/A2 - 50 S
50 L	36	44	M50	15	34	59.25	65.5	A1/A2 - 50 L
63 S	42	49	M63	15	34	70	77	A1/A2 - 63 S
63 L	48	55	M63	15	34	73	79.5	A1/A2 - 63 L
75 S	55	61	M75	15	34	80.5	89	A1/A2 - 75 S
75 L	62	66	M75	15	37	83.25	92	A1/A2 - 75 L

Kit Packing : Kit packing is inclusive of Gland, Earth Tag & PVC Shroud in one Polythin Bag.

ALUMINIUM CABLE GLAND

We are one of the renowned manufacturers of Aluminium Cable Glands in India. Offered in various specifications, our range is known for dimensional accuracy, ductility and reliability. We also meet customized requirements of our customers.

Material : Aluminium Alloys

Series : BW & CW

Standard : BS 6121

IP Rating : IP66

Operating Temp. Range: standard seals 20 c to 80 c

Application : Dry indoor for use with all types of extruded bending cable and use for aluminum armoured termination

Size : M20 to M63



CWA Alu. Cable Glands Application : For Indoor/Outdoor for use with all types of extruded bending cable and are use for aluminum armoured termination.

Our range of E1W Cable Gland is used with all types of SWA extruded bedding cable where it is essential to produce IP 66 seal on to the outer sheath. This also produce an IP 66 or explosion proof seal on inner sheath. It provides seals on to both inner sheath and outer sheath of the cable. These are also available with CIEL (cast integral earth lug).

Application : For use with all types of SWA extruded bedding cable where it is essential to produce IP 66 seal on to the outer sheath and also produce an IP 66 or explosion proof seal on inner sheath. It provides seals on to both inner sheath and outer sheath of the cable.

Design Features : 2 part armour / Earth Lock , Knurled Armour Lock produces a low resistance earth clip, Inner and outer displacement, Rated at IP 66 in conjunction with entry thread seal. This is also available in CIEL (cast integral earth lug) for orders add "C" to prod. code."

Material : Brass
Finish : Brass Finish
Standard : BS 6121

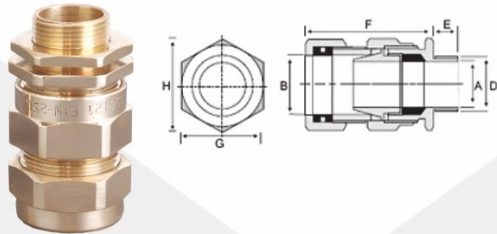

Cable Gland Size	Cable Dimensions Accomodate		Gland Dimensions					Globex Product Code
	Under Armour Dia. A	Overall Dia. B	ISO Entry Thread		Approx Length from Shoulder F mm	Hexagonal Size		
			Dia D mm	Length E mm		Across Flat C mm	Across Corners H mm	
16 S	8	11	16	10	45	20	22	GE1W - 16 S
16 L	9	13.5	16	10	45	22	24	GE1W - 16 L
20 S	12	15	20	10	45	22	24	GE1W - 20 S
20 L	14	20	20	15	45	27	30	GE1W - 20 L
25 S	18	23.5	25	15	50	31	34	GE1W - 25 S
25 L	20.4	27	25	15	50	35	38.5	GE1W - 25 L
32 S	24.5	30	32	15	60	41.5	46.5	GE1W - 32 S
32 L	26.5	32	32	15	60	43	48	GE1W - 32 L
40 S	29	38	40	15	60	50	57	GE1W - 40 S
40 L	32.5	41.5	40	15	60	51	58	GE1W - 40 L
50 S	39	45	50	15	65	58	65	GE1W - 50 S
50 L	44	53	50	15	65	65	72	GE1W - 50 L
63 S	50.5	60.5	63	15	65	73.5	82	GE1W - 63 S
63 L	56	65	63	15	65	78	87	GE1W - 63 L
75 S	58	71	75	15	75	84	93	GE1W - 75 S
75 L	66.5	78.5	75	15	75	94	104	GE1W - 75 L
90 S	78	94	90	20	90	104	115	GE1W - 90 S
90 L	80	96	90	20	90	112	125	GE1W - 90 L

Kit Packing : Kit packing is inclusive of Gland, Earth Tag & PVC Shroud in one Polythin Bag.

E1W / E1WF INDUSTRIAL GLAND

We offer a wide range of E1W/E1WF Industrial Glands

- * Used in indoor and outdoor conditions.
- * Suitable for all types of SWA, Plastic or Rubber
- * Sheathed extruded bedded cables.
- * Provided with inner and outer seals.

Cable Gland Size	Standard Entry Thread	Min. Thread Length	Cable Dia. A	Cable Dia. B		Armour Wire Diameter	Globex Product Code
				Min.	Max.		
20S	20	10	11.6	11.4	15.1	0.9/1.25	G1WF- 20S
20	20	10	13.9	15	20.9	0.9/1.25	G1WF- 20
25	25	10	19.9	20.3	27.4	1.25/1.60	G1WF- 25
32	32	10	26.2	26	33.9	1.60/2.00	G1WF- 32
40	40	15	32.1	31	40.4	1.60/2.00	G1WF- 40
50S	50	15	38.1	36.5	46.7	2.00/2.50	G1WF- 50S
50	50	15	44	43	53.1	2.00/2.50	G1WF- 50
63S	63	15	50	48.9	49.4	2.5	G1WF- 63S
63	63	15	55.9	58	65.9	2.5	G1WF- 63
75S	75	15	61.9	60.6	72.1	2.5	G1WF- 75S
75	75	15	67.9	64.9	78.5	2.50/3.15	G1WF- 75

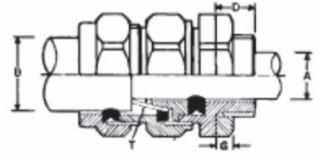

BW ROTATING CONE GLAND

Our range of BW Rotating Gland is manufactured using quality raw material and is available specially on request

- * Body and Locknut made form Nickel Platted Brass.
- * Two Piece design without loose parts.
- * Floating cone for easier clamping of armour wires.
- * Metric Mounting thread.
- * SABS - 0142 certificate

Material : Brass

Finish : Brass Finish or Nickle Finish

Standard : BS 6121

IP Rating : IP30

Operating Temp. Range : Standard Seals -20° to +80°C

Kit Packing Available

Cable Gland Size	Max. Cable Size		Mounting Thread Size Length (C)	Overall Length (D)	Hexagon Size (E)	Globex Product Code
	OD (A)	OD (B)				
00-20S	14	9	M20 10	20	20	GBWR-00
0-20S	16	12.6	M20 10	21	22.5	GBWR-0
1-20	19.3	15.7	M20 10	24	27	GBWR-1
2-25	26.5	20.3	M25 10	27	35	GBWR-2
3-32	33.5	27.2	M32 10	29	42	GBWR-3
4-40	40.5	34.9	M40 15	34.5	52	GBWR-4
5-50	50.5	44	M50 15	42.5	65	GBWR-5
6-63	63	56	M63 15	47.5	75	GBWR-6
7-75	75	69	M75 15	50	82	GBWR-7

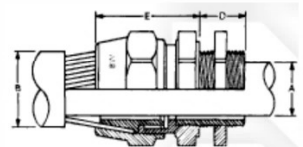

PG BRASS CABLE GLAND (NICKEL PLATED)

We offer a wide range of Nickel Plated Brass Cable Gland with PG Thread for Unarmored. These are used in Outdoor & Indoor applications and in all braided unarmored cable fittings. Offered in sizes from PG - 7 to PG - 48, these are available in nickel-plated finish.

Application : To DIN 46320 / 46255 available with strain relief facility with round or hex intermediate sockets and long and short anti threads.

Thread	Globex Product Code
PG - 7	GPG - 7
PG-9	GPG - 9
PG - 11	GPG -11
PG -13.5	GPG -13.5
PG - 16	GPG -16
PG -21	GPG-21
PG -29	GPG - 29
PG -36	GPG - 36
PG -42	GPG - 42
PG -48	GPG - 48



IP68 METAL GLAND (Metric Thread)

we offer a wide range of Nickel Plated Brass Gland - IP68 Rating - Metric Thread that is used for unarmored PVC, XLPE and other synthetic cables. Our range of Nickel Plated Brass Gland is known for the following features:

- * Superior strain relief
- * Nickel-plated brass for corrosion protection
- * Incorporates a unique camera shutter principle, which protects the cable
- * Fully insulated by plastic insert
- * Neoprene seal for fluid tightness

Material :

- * Brass nickel plated
- * Polyamide 6 insert (self extinguishing)
- * Neoprene seal (self extinguishing)
- * Neoprene O-Ring (self extinguishing)
- * Continuous operating temperature: -20 to + 120°C
- * Chemical resistance: Resistant to normal organic solvents, mineral, animal and vegetable oils and fat, petrol
- * Threading: According to IEC 423, EC 423A and EN 60423
- * IP rating: IP68

This Metal Gland is a new unique product that is very different from traditional Metal Glands

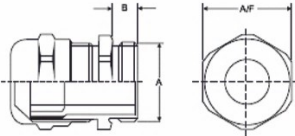

Standard : BS EN 50262 : 1999
Ingress Protection : IP68
Finish : Nickel Finish



Cable Gland Size	Mounting Thread		Min.	Max.	Width A/F mm	Globex Product Code	Pack Code
	A Dia. mm	A Length mm	Cab. Ran. mm	Cab. Ran. mm			
5	12	5	3	6	14	GIP68 -12	40
5	16	5	5	10	17	GIP68 -16	20
6	20	6	8	13	22	GIP68-20	20
7	25	7	11	17	27	GIP68 -25	10
8	32	8	15	21	34	GIP68-32	5
8	40	8	19	28	43	GIP68-40	3
9	50	9	26	35	55	GIP68-50	1
10	63	10	32	42	65	GIP68-63	1

IP68 METAL GLAND (PG Thread)

we offer a wide range of Nickel Plated Brass Gland - IP68 Rating - PG Thread

Material : Body with Locknut Bright Nickel Plated.

Insert : Polyamide-6, Sealing Ring-Neoprene

O' Ring : Nitril

Protection class : IP68 - 5 BR

Application : Cable glands are suitable for connection provides with flexible cables and wherever protection against dust, liquid and strain is required in industrial use and domestic application too.

Standard : BS EN 50262 : 1999

Finish : Nickel Finish

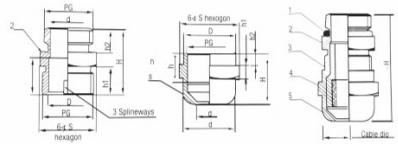

Cable Gland Size	Dimensions							Dimensions							Globex Product Code	
	D	d	H	S	h	h1	h2*	D	d	H	S	h	h1	h2*		H*
3 - 6.5	13.9	6.5	13	14	8.5	3.5	3	9.6	9	16.5	14	9	7	6 (10)	26	GPG - 7
4 - 8	16.8	8.5	14	17	9	3.5	3.5	12.5	11	17	17	15	7.5	6 (10)	27	GPG - 9
5 - 10	19.8	10.5	16	20	9.5	3.5	3.5	15	13.5	17	20	13.5	7.5	6 (10)	28	GPG - 11
6 - 12	21.8	12	15	22	11	3.5	3.5	17	14	17	22	14.5	7.5	6.5 (10)	28	GPG - 13
10 - 14	23.8	14.5	17	24	12.5	4	4	19	16	20	24	16.5	10	6.5 (10)	30	GPG -16
13 - 18	29.7	18.5	20.5	30	13	4	4	24	20.5	22	30	16.5	11	7 (12)	35	GPG - 21
18 - 25	39.5	25	24	40	15.5	5	5	32	28.5	26	40	19.5	16	8 (12)	40	GPG - 29
22 - 32	49.7	33	31	50	20.5	7.5	5	40	35	30	50	19.5	16	10 (15)	48	GPG - 36
30 - 38	56.5	39	26.5	58	17.5	8.5	4.5	49	43	35	58	23	15	12 (15)	54	GPG - 42
34 - 44	63.5	44.5	25	64	13.5	7	4	54	54	30	34	30	13	10 (14)	58	GPG - 48

MARINE CABLE GLAND

We offer Marine -Use Watertight Cable Glands in nickel-plated finish. This is available in sizes of sizes from 3/8" to 3" inches

Material : Brass

Finish : Bright Nickle Plated

IP Rating : IP 66

Parts : Body, Clamping Gland, Lock Nut, Ywo Brass Washers, Rubber Thread Seal, Rubber Inner Compression Ring.

Operating Temp. Range : Standard Seals -20° to +80°C



Cable Gland Size	Pipe Thread	Rubber ID	OD Lock Nut	OD of Gland	Total Length
CG - 10	PF3/8	8	28	22	38
CG - 15	PF 1/2	10	31.5	28	42
CG - 20	PF3/4	13	37	33.5	46
CG - 25	PF 1	15	45	42	52
CG - 30	PF 1 1/4	24	46	49.5	57
CG - 40	PF 1 1/2	30	63	55	65
CG - 40	PF 1 1/2	34	63	55	65
CG - 45	PF 2	38	77	69	73
CG - 50	PF 2	44	77	69	73
CG - 55	PF 2 1/2	48	96	85	83
CG - 60	PF 2 1/2	54	96	85	83
CG - 65	PF 3	60	112	100	95
CG - 70	PF 3	64	112	100	95

EMC CABLE GLAND (IP68 Rating - Nickel Plated)

These Gland are used in applications which involve shielded cables for electromagnetic protection. These glands help in maintaining the electromagnetic integrity of the shielded cable by just tightening the gland. To get protect shielding the outer sheath of the cable is stripped by approximately 10mm. This stripped cable is passed through the EMC gland. Tightening the gland enables a special spring inside the gland to come in contact with the cable braiding. This is not only helps in electromagnetic shielding but also give an IP68 protection level along with strain relief to the cable. cable glands with long thread of reduced clamping range are also available on request.

Material : Brass Nickel Plated
Plastic Insert : Polyimide - 6
EMC Spring : Copper Beryllium
Sealing Ring : Neoprene
'O' Ring : Perbunan (NBR)
Protection Class : IP-68
Thread available : PG & Metric



Metric Thread

Gland Size	Thread Length (mm)	A/F mm	Clamping Range (mm)	Globex Product Code Long
M 12 X 1.5	6	14	3-6.50	GE-M12
M 16 X 1.5	7	20	6-10.0	GE-M16
M 20 X 1.5	8	22	6-14.0	GE-M20
M 25 X 1.5	8	27	11-17.0	GE-M25
M 32 X 1.5	8	34	16-21.0	GE-M32
M 40 X 1.5	9	43	18-28.0	GE-M40
M 50 X 1.5	13	57	26-35.0	GE-M50
M 63 X 1.5	13	68	33-43.0	GE-M63

PG Thread

Gland Size	Thread Length (mm)	A/F mm	Clamping Range (mm)	Globex Product Code Long
PG - 7	6	14	3-6.50	GE PG - 7
PG - 9	6	17	6-9.0	GE PG - 9
PG - 11	6	20	5-10.0	GE PG - 11
PG - 13.5	6.5	22	5-12.0	GE PG - 13.5
PG - 16	6.5	24	10-14.0	GE PG - 16
PG - 21	7.5	36	13-18.0	GE PG - 21
PG - 29	8	40	18-25.0	GE PG - 29
PG - 36	9	50	22-32.0	GE PG - 36
PG - 42	12	57	30-35.0	GE PG - 42
PG - 48	14	64	34-44.0	GE PG - 48

ALCO CABLE GLAND

Size : G204 to G 755
Material : Brass
Finish : Nickel Plated
Standard : BS 6121
IP Rating : IP30
Operating Temp. Range : -80° to +600°C
Thread : Metric
Application : Used with SWA , plastic and rubber sheathed cables.
 Used indoor conditions inner ring frames positive armour clamp an earth continuity.
 Material is brass and Nickel Plated.



TRS CABLE GLAND

We Manufacture TRS Cable Glands as per Custom Specifications (Drawing and Samples)

Application : Recommended for use with Braided, Co-Axial or SWA cables. A rubber Seal compresses on tightening to provide a tight fit against cable.

Gland Size	Entry Thread "C" (Metric)	Length "D"	Cable Dia. "A" Max	Cable Dia. "B" Max	Across Corners	Across Corners	Globex Product Code Long
16	16	8	3.0	7.0	20.0	23.0	GTRS-16
20S	20	10	7.0	10.0	24.0	27.0	GTRS-20S
20	20	10	10.0	14.5	27.7	31.0	GTRS-20
25	25	10	14.5	20.5	35.0	39.0	GTRS-25
32	32	10	20.5	26.5	43.0	47.5	GTRS-32
40	40	15	26.5	34.5	51.5	57.0	GTRS-40
50	50	15	34.5	43.5	58.5	65.0	GTRS-50



CXT CABLE GLAND

We Manufacture CXT Cable Glands as per custom Specifications (Drawing and Samples) This is used for all types of screened flexible wire braid (e.g. CY/SY) or wire braid armoured cable. CXT cable Gland for internal or external use with metal braided cable with outer seal given moisture proof protection to BS6121.

Size : 16mm to 90mm
Material : Brass
Thread : Metric, NPT & PG
Finish : Brass Finish or Nickel Finish
Standard : BS 6121
IP Rating : IP66 & IP68
Operating Temp. Range : -20° to +80°C

Kit Packing Available

Size (mm)	Cable OD		Globex Product Code Long
	Min.(mm)	Max.(mm)	
16	3.10	8.60	GCXT-16
20S	5.90	11.50	GCXT-20S
20	6.40	1.50	GCXT-20
25	10.00	19.50	GCXT-25
32	19.00	25.50	GCXT-32
40	25.00	32.00	GCXT-40
50S	29.80	38.10	GCXT-50S
50	36.90	43.30	GCXT-50
63S	42.20	49.90	GCXT-63S
63	48.30	54.90	GCXT-63
75S	54.20	62.00	GCXT-75S
75	59.80	66.90	GCXT-75
90	66.60	79.30	GCXT-9



WIPING GLAND

Wiping Gland that is manufactured from heavy duty brass. Wiping Glands are made as per customers drawings & specifications. These are made from heavy duty brass. Wiping glands are made as per customers drawings & specifications. Proof protection to BS6121.

Size : X, Y & Z
Material : Brass
Application : For use with SWA plastic and rubber- (Elastomer) sheathed cables. Used in dry indoor conditions.

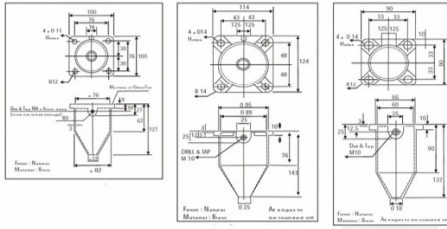

Gland Size	Dia. over metal sheath of cable
X	12 to 51
Y	25 to 78
Z	25 to 94



CABLE GLAND KIT

We offer an exclusive range of Gland Kit in kit packing. These include 2-Brass glands, 2-Black PVC shrouds, 2-Galv, steel locknuts, and 2-Brass earthtags. The detailed specification is mentioned below:

16/20 -32 inclusive
 » 2-Brass glands
 » 2-Black PVC shrouds
 » 2-Galv, steel locknuts
 » 2-Brass earth tags

40-90 inclusive
 » 1-Brass gland
 » 1-Black PVC shrouds
 » 1-Galv, steel locknuts
 » 1-Brass earth tags



DOUBLE COMPRESSION TYPE CABLE GLAND

Our range of Double Compression Type Brass Cable Gland (Weather Proof & Flame Proof) for armoured Cable helps in providing electrical continuity between armour cable and gland entry component. Also provides a seal on the outer sheath of the cable, thus ensuring no damage to cable sheathing. These are used both in indoor and outdoor applications, in all climatic conditions, as these are weatherproof & waterproof.

Material : Brass (IS-319) Standard (Alu. / S.S. / M.S. also available)

Finish : Nickel Plated Standard (Chrome also available)

Entry Threads : BSC / ET (PG / Metric / NPT / BSP also available)

Sealing Rubber Ring : Nitrile / Neoprene

Gland Standard : BS 6121 & ISIC IS/IEC - 60529-2001 / 0-2017

Certification : CSIR - CIMFR, Dhanbad Approved

Application: Weather Proof (WP) : Generally for outer & indor use for armoured & unarmoured cables. Flame Proof (FP) : Generally use in flammable Gas/ vapour area suitable for Gas Group I, IIA & IIB

Series : GBW / GBF

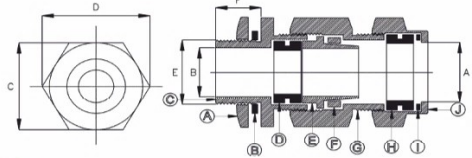

Part of Gland

- A - Check Nut
- B - Flat washer
- C - Nipple entry thread
- D - Neoprene inner rubber
- E - Armour clamping cone
- F - Armour clamping ring
- G - Gland body
- H - Neoprene outer rubber
- I - Skid washer
- J - Compression nut

Suitable Overall Dia.		Weather Proof Double Compression Glands GBW Series	F Length (GBF Series) mm	Flame Proof Double Compression Glands GBF Series	F Length (GBF Series) mm	A Dia. mm	B Dia. mm	C (A/F) mm	D (A/C) mm	E Nipple Size (E.T. / B.S.C.)
From	To									
6.0	12.5	GBW 01SS	13	GBF 01SS	25	13	13	22.5	25	3/4"
12.0	16.5	GBW 01S	15.2	GBF 01S	25	18	14.5	25	29	3/4"
16.5	18.5	GBW 01	15	GBF 01	25	19.5	14.5	27.5	31.5	3/4"
16.5	18.5	GBW 01A	15	GBF 01A	25	19.5	14.5	27.5	31.5	1"
18.5	20.0	GBW 02	15	GBF 02	25	23	18	30	35	1"
18.5	20.0	GBW 02A	15	GBF 02A	25	21	19	31	35.5	3/4"
20.0	23.0	GBW 03	15	GBF 03	25	23	19.5	31.5	36	1"
23.0	26.0	GBW 04	15	GBF 04	25	27.5	21	36	41.5	1"
23.0	26.0	GBW 04A	15	GBF 04A	25	28	23	36	41.5	1.1/4"
26.0	30.0	GBW 05	15	GBF 05	25	32	25.5	41	47.5	1.1/4"
26.0	30.0	GBW 05A	15	GBF 05A	25	32	26	41	47.5	1.1/2"
30.0	33.0	GBW06	15	GBF06	25	34.5	31.5	46	53.5	1.1/2"
30.0	33.0	GBW 06A	15	GBF 06A	25	34.5	26.5	46	53.5	1.1/4"
33.0	37.0	GBW 07	15	GBF 07	25	38.5	32	49.5	57	1.1/2"
37.0	41.0	GBW 08	15	GBF 08	25	43	39	56	64.5	2"
41.0	46.0	GBW 09	15	GBF 09	25	47.5	40	58	67	2"
46.0	52.0	GBW 010	20	GBF 010	25	54	45	65	75	2"
46.0	52.0	GBW 010A	20	GBF 010A	25	53	47	65	75	2.1/2"
52.0	54.0	GBW 011A	20	GBF 011A	25	55	56	72.5	84	2.1/2"
54.0	61.0	GBW 011	20	GBF 011	25	62.5	56.5	79	91	2.1/2"
61.0	66.0	GBW 012	20	GBF 012	25	68	64	84	97	3"
66.0	72.0	GBW 013A	20	GBF 013A	25	73	66.5	89	102.5	3"
72.0	78.0	GBW 013	20	GBF 013	25	80	74	89	113	3.1/4"
78.0	84.0	GBW 014	20	GBF 014	25	85	78	105	121	3.1/2"
84.0	94.0	GBW 015	20	GBF 015	25	97	90.5	114	132	4"
94.0	104.0	GBW 016	20	GBF 016	25	106	101	130	149	4.1/2"

Note: Full range of weather proof double compression cable glands are available for unarmoured type of cables.

SINGLE COMPRESSION TYPE CABLE GLAND

Our range of Single Compression Type Brass Cable Gland for Unarmoured Cable helps in providing electrical continuity between unarmoured cable and gland entry component. Also provides a seal on the outer sheath of the cable, thus ensuring no damage to cable sheathing. These are used both in indoor and outdoor applications, in all climatic conditions, as these are weatherproof & waterproof.

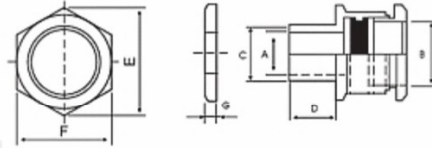

Part of Gland

- A - Check Nut
- B - Main gland body
- C - Metal washer - 3 nos.
- D Outer Shell Rubber
- E Compression Ring

SINGLE COMPRESSION TYPE CABLE GLANDS												
Max. O.D.	Cable Dimm. Overall Dia.		Nipple Entry Thread		Cable Gland Dimension							Globex Product Code
	Over	Under	Inch	mm	A	B	C	D	E	F	G	
14	12	10	3/8"	10	11.5	12.5	15.5	7.5	20.5	18	2.5	GC 3/8"
16	15	10	1/2"	12	12	15	15.5	8.5	25	22	3	GC 1/2"
16	16	10	5/8"	16	14.5	16.5	18.5	8	24	21	2.5	GC 5/8"
18	16.5	14	3/4"	19	14.5	17.5	19	8.5	26	23	2.5	GC 3/4"
20	17.5	16.5	7/8"	22	14.5	20	18.5	8.5	29	25	3	GC 7/8"
23	20.5	18.5	1"	25	20.5	23	25	9	33	29	3	GC 1"
30	27.5	22.5	1-1/8"	28	24	28	28.5	10.5	40	35	3.5	GC 1-1/8"
30	27.5	26.5	1-1/4"	32	27	32	31.5	11	46	40	3.5	GC 1-1/4"
33	33	29.6	1-3/8"	35	29.5	35.5	34.5	11	50	44	4	GC 1-3/8"
38	37	33.5	1-1/2"	38	33	39.5	38	11.5	54	47	4	GC 1-1/2"
45	40	37.5	1-3/4"	45	40	44.5	44	11.5	62	54	4.5	GC 1-3/4"
49	43	43.5	2"	50	45	51.5	50	13	69	60	5	GC 2"
55	52	49	2-1/4"	57	51.5	58	56.5	13	78	68	5	GC 2-1/4"
61	56	64.5	2-1/2"	63	57.5	62.5	63	4	82	72	5	GC 2-1/2"
67	67	61.5	2-3/4"	70	63.5	69	69	15	90	80	5	GC 2-3/4"
73	73	66.5	3"	75	68	75	75	16	99	87	5.5	GC 3"
80	74	72.5	3-1/4"	82	75	81.5	82	16	105	92	6	GC 3-1/4"
83	83	80.5	3-1/2"	88	81.5	86.5	88	16	115	102	6	GC 3-1/2"
95	95	84	4	100	92	101	100	17	126	110	6.5	GC 4"
105	108	100	4-1/2"	112	107	109	105	20	148	129.5	7.5	GC 4-1/2"

SHROUD / HOOD / SLEEVES

We manufacture a wide range of PVC SHROUD that is manufactured using high grade Polyvinylchloride. Our range is widely demanded amidst our clients, as these are known to provide additional protection & enhances IP rating of the Gland Termination.

Material : Block Polyvinylchloride high grade(also available LSF shroud)

Features :

Provides additional protection & enhances IP rating of the Gland Termination.
Effective solution to weater and corrosion protection of a cable gland.
Available in same fland size compatible to each size of the cable gland.
The arrow end of th sleeve is readily cut with a knifem enabling it to be slipped over a wide range of cable diameters and assist ease of installations.

Shroud available in PVC / LSF / FRLS / LSZH on request.



EARTHING TAG

We have the proficiency in offering Earthing Tag in various shapes and in all sizes. This tags act as a means of connection or an earth bond around the cable gland. Fabricated using brass, aluminum & copper, this ensures earth continuity between the electrical equipment and to gland. It can also be coated or plated as per customer specifications.

Material : Brass or Aluminium

Features : Means of connection or an earth bond around the cable gland.

Available in various shapes and in all sizes.

Ensures earth continuity between the electrical equipment & to gland.

Can be coated or plated as per Customer Specification.

Metric / Size	Globex Product Code Long
M16	GET-16
M20	GET-20
M25	GET-25
M32	GET-32
M40	GET-40
M50	GET-50
M63	GET-63
M75	GET-75
M90	GET-90
M100	GET-100



LOCK NUT

Our range of Lock Nut is designed by our team of technocrats who uses quality raw material like Brass, Aluminum and Galvanized Steel. Available in Metric, Imperial, NPT, BSPT, BSP, & PG, these are used in fastening glands to the gland plate.

Size (mm or inch)	Globex Product Code
20mm or 3/4"	GLN-20
25mm or 1"	GLN-22
32mm or 1.1/4"	GLN-32
40mm or 1.1/2"	GLN-40
50mm or 2"	GLN-50
63mm or 2.1/2"	GLN-63
75mm or 3"	GLN-75
90mm or 3.1/2"	GLN-88



BRASS REDUCER

Material : Brass
Finish : Nickel Plated
Size Range : 1/2" to 3"
Thread : ET (BSC) Thread as standard - NPT / PG / BSP / MM is available on request
Application : to close any unutilized places.

Any kind of special Brass reducer can be manufacture as per customer drawing, sample & specifications.



BRASS STOPPING PLUG

Material : Brass
Finish : Nickel Plated
Size Range : 1/2" to 3"
Thread : ET (BSC) Thread as standard - NPT/PG/BSP/MM is available on request
Application : to close any unutilized places

Any kind of special Brass Stopping Plug can be manufacture as per customer drawing, sample & specifications.



MECHANICAL CABLE LUGS

Mechanical cable lugs - bolted with 2 screws and 4 screws

Material : Brass Nickel / Tin plated.
Zinc Plated Steel Bolt.

Cable mm ²	Dimension				Screw	Type	Globex Product Code
	A	G	D	J			
10	4	6	15	32.5	M - 5	I	G2B 10
16	5.1	8.5	17	37	M - 5	I	G2B 16
25	6.3	8.5	18.75	42	M - 5	I	G2B 25
35	7.5	10.5	21.5	4	M - 5	I	G2B 35
50	9.5	10.5	23	56.5	M - 6	II	G4B 50
75	11	13.25	26	61	M - 6	II	G4B 75
100	13	14.3	29	65	M - 6	II	G4B 100
120	14	14.8	32	71	M - 6	II	G4B 120
170	16	16	33	81	M - 8	II	G4B 170
200	17	17	35	85	M - 8	II	G4B 200
250	18	17	38	87.5	M - 8	II	G4B 250
300	21	19.8	45	118	M - 10	II	G4B 300
400 / 500	25.5	22	53	132	M - 10	II	G4B 400/500
700	34	22	60	150	M - 10	II	G4B 700

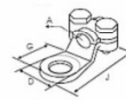

Type I

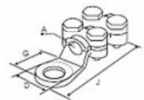

Type II

COPPER BONDED GROUND ROD

"LOBEX" copper bonded earth rod are made from low carbon steel of grade BS 970 or AISI 1018 with a high tensile strength of atleast 600 N/mm². Low carbon steel core are molecularly bonded with 99.9% pure electrolytic copper.

Silent Features :

Perfectly bonded rod will last longer, drive easier and will not crack. Corrosion resistance while providing the lowest resistance to ground. Threads are rolled by roll threading process, which ensures that a thin copper cover is maintained, even at the root of the thread. Roll thread gives greater strength than cut thread. The rolling process raises the surface of the rod, so that Thread dia. (T) is greater than Shank dia. (S).

"Globex" also offers other sizes as per customer specification.

Dimensions Rod Size (Dia. x Length)	Actual Rod Dia. 'S' in	Thread Dia. 'T' in	Globex Product Code
9.5 x 1200 (UN-THREADED)	9.5	-	GBR 012
9.5 x 1800 (UN-THREADED)	9.5	-	GBR 018
14 x 1200	12	14	GBR 1412
14 x 1500	12	14	GBR 1415
14 x 1800	12	14	GBR 1418
14 x 2000	12	14	GBR 1420
14 x 2400	12	14	GBR 1424
5/8"x4' or 16mm x 1200	14.2	5/8"	GBR 112
5/8"x5' or 16mm x 1500	14.2	5/8"	GBR 115
5/8"x6' or 16mm x 1800	14.2	5/8"	GBR 118
5/8" x 8' or 16 mm x 2400	14.2	5/8"	GBR 124
5/8" x 10' or 16 mm x 3000	14.2	5/8"	GBR 130
5/8"x 4 or 16mm x 1200	16	5/8"	GBR 312
5/8 x 5 or 16 mm x 1500	16	5/8"	GBR 315
5/8 x 6 or 16 mm x 1800	16	5/8"	GBR 318
3/4"x 4 or 19 mm x 1200	17.2	3/4"	GBR 212
3/4"x 5 or 19 mm x 1500	17.2	3/4"	GBR 215
3/4"x6 or 19mm x 1800	17.2	3/4"	GBR 218
3/4"x8 or 19mm x 2400	17.2	3/4"	GBR 224
3/4"x10 or 19 mm x 3000	17.2	3/4"	GBR 230



COUPLER

Coupler joins lengths of threaded copper bond earth rods together

Material : Brass/Copper Alloy

Couplers are made from copper alloy & counter bored to completely enclose threads & protect from damage and corrosion.

Coupler Length can be made as per customer specification

Size (mm or inch)	Globex Product Code
12 mm	GEC 12
14 mm	GEC 14
5/8" or 16 mm	GEC 16
3/4" or 19 mm	GEC 19
1" or 25 mm	GEC 25



DRIVING STUD

Driving Stud are used to drive tee Earth Rod to the Ground.

Metal : high tensile steel

These are used to drive tee earth rod to the ground.

Size (mm or inch)	Globex Product Code
14 mm	GDS 14
5/8 or 16 mm	GDS 16
3/4" or 19 mm	GDS 19
1/2"	GDS 12



CLAMP - A TYPE

This is used to forming the connection between tape & earth rod.

Suitable for Rod Dia 9.5 to 12mm
Material : Brass with MS Fastener

Size (mm or inch)	Globex Product Code
9.5	GAC - 1
12	GAC - 2



ROD TO TAPE EARTH CLAMPS - B TYPE

This is used to forming the connection between tape & earth rod.

Material : Brass with MS Fastener
 Also available in Gunmetal.

Size	Max. Cond.	Globex Product Code
5/8"	26 x 12	GBC 1
5/8"	40 x 12	GBC 2
5/8"	51 x 12	GBC 3
3/4"	26 x 12	GBC 4

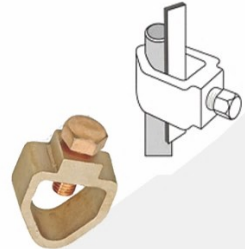

ROD TO CABLE CLAMPS - D TYPE

Material : Brass
 Also available in Gunmetal.

Size	Max. Cond.	Globex Product Code
5/8"/16	35mm ²	GCC 1
5/8"/16	50mm ²	GCC 2
3.4"/20	70mm ²	GCC 3
3/8"/9.5	95mm ²	GCC 4



ROD TO CABLE CLAMPS - C TYPE

Material : Brass with MS Fastener
 Also available in Gunmetal.

Size	Max. Cond.	Globex Product Code
3/8" / 9.5	35mm ²	GCC 1
5/8" / 16	50mm ²	GCC 2
5/8" / 16	70mm ²	GCC 3
3/4" / 20	95mm ²	GCC 4

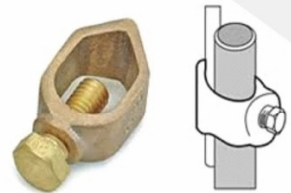

U BOLT ROD CLAMP

These are made from Copper with Gunmetal plate it can be supplied for all the rods from 5/8" to 1" and copper tape.

Nom Rod Dia.	Hole Centres	Globex Product Code
5/8"	37 m	GUU 16
3/8"	37 m	GUU 20
1"	37 m	GUU 25

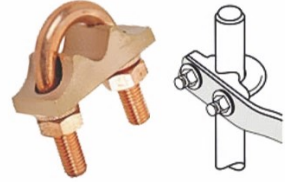

U BOLT CABLE CLAMP

these are made from Copper with Gunmetal plate and used for connecting Rod to cable
Available with different Rod and cable sizes

Nom Road Dia.	Hole Centres	Globex Product Code
7/8" to 16 mm	16-95	GURC 1
3/4" to 20 mm	16 - 70	GURC 2
1" to 16mm	70 - 185	GURC 3
1" to 16mm	70 - 150	GURC 4

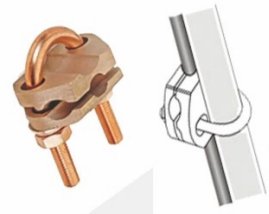

OBLONG TEST CLAMP

Material : Gunmetal / Brass
These are used with Bare Copper Tape Conductor.

Conductor Size (mm)	Globex Product Code
25 x 3	GOT 253
25 x 6	GOT 256
40 x 6	GOT 406
50 x 3	GOT 503
50 x 6	GOT 506

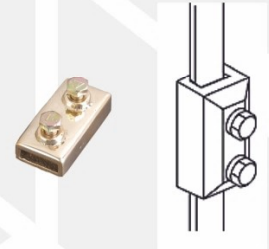

DC TAPE CLIP

Material : Brass / Gunmetal
These are used with Bare Copper Tape Conductor.

Conductor Size (mm)	Globex Product Code
20 x 3	GDTC 203
25 x 3	GDTC 253
25 x 6	GDTC 256
32 x 3	GDTC 323
40 x 6	GDTC 406
50 x 3	GDTC 503
50 x 6	GDTC 506

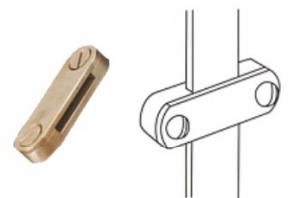

TAPE CLIP

Material : Brass

These are used with Bare Copper Tape Conductor.

Conductor Size (mm)	Globex Product Code
20 x 3	VTC 203
25 x 3	VTC 253
50 x 6	VTC 506

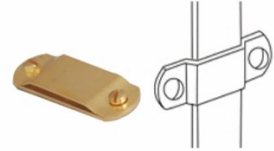

TEST BOND / TEST CLAMP

Material : Gunmetal / Brass

These are used with for 4 way Copper Tape Conductor.

Conductor Size (mm)	Globex Product Code
26 x 12	GTBC 2612



CABLE TO TAPE JUNCTION CLAMP

Material : Gunmetal / Brass

These are used with connecting copper tape to cable.

Tape Size mm	Cabl Size mm ²	Globex Product Code
25 x 3	50	VCTJ 253

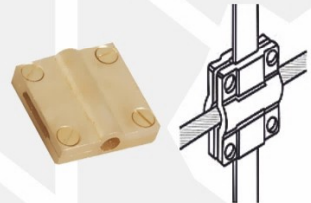

SQUARE TAPE CLAMP

Material : Brass / Gunmetal

These are suitable for Four way connections of copper tape.

Conductor Size (mm)	Globex Product Code
25 x 3	GSTC 253
25 x 4	GSTC 254
25 x 6	GSTC 256
32 x 3	GSTC 323
40 x 6	GSTC 406
50 x 3	GSTC 503
50 x 6	GSTC 506



BRASS CABLE CLIP

Used for connecting 13mm rod to a cable range of 6 - 16mm²

Product Code : GBCC-1

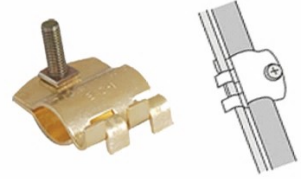

TEE CLAMP

Material : Copper / Brass

These are used for forming and bonding Tee joint for conductor.

Conductor Size (mm)	Globex Product Code
8 Cu	GTEC 8C
8 Al	GTEC 8A

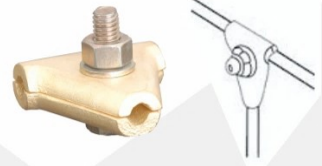

JOINTING CLAMP

Material : Copper / Brass

These are used for forming straight through joints.

Conductor Size (mm)	Globex Product Code
8 Cu	GJC 8C
8 Al	GJC 8A



CAST CABLE SADDLE

Material : Copper / Brass

Conductor Size (mm)	Globex Product Code
8	GBCC-8
10	GBCC-10



LINETAPE / SPLIT BOLT

We offer a wide range of line taps to meet the material and dimensional specifications laid by different international standards. Brass line taps are made with high tensile brass as per BS 2874 – CZ 112. Threads are formed by rolling process giving the nut extra clamping force. Pressure pads are made from extruded bars (not cast), preventing the pads from cracking. Brass line taps are manufactured in passivated natural brass with electro tinned finish. These are also supplied in high conductivity copper.



Globex Product Code	Size	J	C	B a/f	D a/f	F
GSBC 6	6	19.85	4	12.7	13.35	4.8
GSBC 10	10	26.75	4.7	12.7	19	5.6
GSBC 16	16	26	5.7	12.7	19	5.6
GSBC 25	25	28	7.3	16	19	5.6
GSBC 35	35	35	7.8	18.5	24	6.35
GSBC 50	50	42	9.7	24.1	27.2	8.65
GSBC 70	70	44	11.5	24.1	27.2	8.65
GSBC 95	95	50	14.4	26.5	35.4	9.4
GSBC 120	120	57.5	16.2	30	35.4	12
GSBC 150	120	57.5	16.2	30	35.4	12
GSBC 185	185	57.5	18.2	31.75	38	12
GSBC 240	240	72.5	22	40	48.2	14.25
GSBC 300	300	72.5	24	42	50	14.25
GSBC 400	400	76.5	26	48	56	16
GSBC 500	500	80	30	55	65	16

BRASS NEUTRAL LINK / BRASS EARTHING TERMINALS

We are known to offer a vast range of terminal bars / neutral links for the electrical industry. Manufactured using quality raw material, these are available in various sizes and can be customized as per client's requirement.

MATERIAL : Heavy Duty Brass / Nickel / Tin Plated

SCREW : Brass / Zinc Plated S.S Screw.

SIZE : Up to 2 mtr.Long

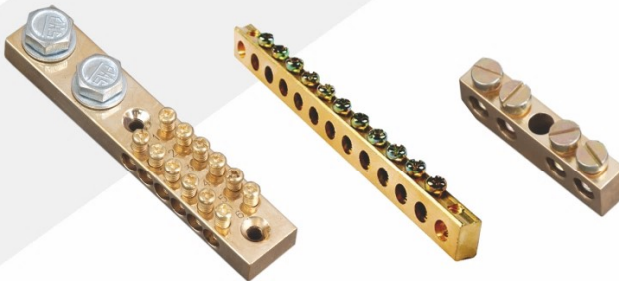

BRASS MALE AND FEMALE BUSH

Material : Brass

BRASS MALE BUSH

Size		Globex Product Code	
mm	Inch	Small	Long
20	(3/4")	GMB -20S	GMB -20L
25	(1")	GMB -25S	GMB -25L
32	(1.1/4")	GMB -32S	GMB -32L
40	(1.1/2")	GMB -40S	GMB -40L
50	(2")	GMB -50S	GMB -50L

BRASS FEMALE BUSH

Size		Globex Product Code
mm	Inch	
20	(3/4")	GFB -20
25	(1")	GFB -25
32	(1.1/4")	GFB -32
40	(1.1/2")	GFB -40
50	(2")	GFB -50



BRASS ADAPTOR - 1 Pc.

Brass Nickel Plated 1Pc. Adaptor for Galvenised Metal Conduit

Material : Brass

Finish : Brass / Nickel Plated.

Range : Male / Female

Thread : Matric / ET

Conductor Size (mm)	Globex Product Code
12	GAF - 12
16	GAF - 16
20	GAF - 20
25	GAF - 25
32	GAF - 32
40	GAF - 40
50	GAF - 50



BRASS ADAPTOR - 2 Pc.

Brass Nickel Plated 2 Pc. Adaptor for PVC Coated Galvanized Conduit

Material : Brass

Finish : Nickel Plated.

Range : Fixed Type / Swivel Type

Thread : Matric / ET

Conductor Size (mm)	Globex Product Code
12	GAFI - 12
16	GAFI - 16
20	GAFI - 20
25	GAFI - 25
32	GAFI - 32
40	GAFI - 40
50	GAFI - 50



PVC COATED GALVENISED FLEXIBLE CONDUIT

Construction : Helically wound, galvanised steel core with enhanced low acid PVC Covering.

Features : Highly flexible & largely resistance to oil, acid and sea water.

Packing : In spool

Standard : As per BS 731 Part I

Properties : High degree of safety

Colour : Black (Grey on request)

Operating Temperature : 15 c to + 80 c

Onduit Size (mm)	Size I.D x O.D	Std. Packaging in Mts.	Globex Product Code Long
16	13 x 17	30	GFI16
20	17 x 21	30	GFI20
25	21 x 26	30	GFI25
32	28 x 33	30	GFI32
40	35 x 40	30	GFI40
50	50 x 55	25	GFI50



DARK FLEXIBLE STEEL CONDUIT SYSTEM

Construction : Highly flexible steel conduit offers good mechanical protection, helically coiled, square locked type to BS 731 : 1952

Material : Galvanized

Finish : Electro Galvanized.

Features : Excellent crush & Pull of characteristic , making it ideal for flexing, bending and vibrating application.

Properties : Strong protection for cable, Compression and impact resistance.

Temperature range : - 500C to 3500C

Conductor Size (mm)	Size I.D x O.D	Std. Packaging in Mts.	Globex Product Code Long
12	12 x 17	30	GFI-12
16	16 x 20	30	GFI-16
19	19 x 22	30	GFI-19
25	25 x 29	30	GFI-25
32	32 x 36	30	GFI-32
35	38 x 42	30	GFI-38
50	50 x 55	25	GFI-50



OVERVIEW OF PRODUCTS

Cable Terminal Ends (Lugs) & In-line Connectors.





GLOBAL BRASS & ALLOY (INDIA)

(An ISO 9001 Certified Company)

Plot No. 3971/3972, 'R' Road, G.I.D.C., Phase-III, Jamnagar-361004, Gujarat, INDIA.

Phone : +91 288 2730227 / 2731303 **Fax :** +91 288 2561949 **Mobile :** +91 80009 30012

E-mail : info@globexworldwide.com / sales@globexworldwide.com

